



VITON ENGINEERS PVT. LTD.

EIL,IBR & ISO 9001: 2015 Certified Company

CAST STEEL GATE VALVE

Bolted bonnet. Outside screw-and-yoke, Rising stem, Non-rising handwheel

Class 150

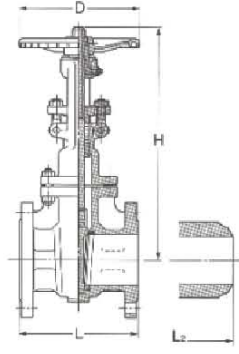

Butt Welding End

Dimensions

Valve Size	in	1 1/2	2	2 1/2	3	4	5	6	8	10	12	14	16	18	20	22	24
		mm	40	50	65	80	100	125	150	200	250	300	350	400	450	500	550
L 1	in	6.50	7.00	7.50	8.00	9.00	10.00	10.50	11.50	13.00	14.00	15.00	16.00	17.00	18.00	19.00	20.00
	mm	165	178	190	203	229	254	267	292	330	356	381	406	432	457	483	508
L 2	in	-	8.50	9.50	11.14	12.00	15.00	15.86	16.50	18.00	19.76	22.50	24.00	26.00	28.00	30.00	32.00
	mm	-	216	241	283	305	305	403	419	457	502	572	610	660	711	762	813
H	in	13.8	15.1	16.9	20.0	23.1	23.1	29.8	37.7	45.7	53.6	60	66.7	74.3	83.5	91.6	98.1
	mm	351	351	430	507	587	587	757	757	958	1162	1361	1523	1693	1887	2120	2326
D	in	7.1	7.1	7.9	9.8	9.8	9.8	11.8	13.8	15.7	17.7	19.7	23.6	23.6	26.8	26.8	29.9
	mm	200	200	200	250	250	300	300	350	400	500	550	600	600	650	650	700

Material Specification

PARTS	MATERIAL	
BODY	WCB / WC6	CF8 / CF8M
BONNET	WCB / WC6	CF8 / CF8M
YOKE 1	WCB / WC6	CF8 / CF8M
WEDGE	13%Cr FACING	CF8 / CF8M
SEAT RING	-do-	T304 / T316 CF8 / CG8M
BACK SEAT	T410	INTEGRAL
SPINDLE	T410	T304 / T316
GLAND BLUSH	T410	T304 / T316
GLAND FLANGE	CARBON STEEL / WCB	S.S. 304
YOKE SLEEVE	ASTM A 439	Gr.D2 / AL-BRONZE
YOKE NUT	CARBON STEEL	S.S. 304
HAND WHEEL	CARBON STEEL	
HAND WHEEL NUT	CARBON STEEL	S.S. 304
STUD & NUT	B7 / 2H / B16 / 7	B7 / 2H
EYE BOLT & NUT	B7 / 2H	B8 / 8
CROSS BOLT & NUT	B7 / 2H / B16 / 7	B8 / 8
GASKET	SPW S.S. 304 / 316 WITH GRAPHOIL	
GLAND PACKING	INCONEL WIRE REIN. / GRAPHOIL / NAB	
GREASE NIPPLE	STEEL	
NAME PLATE	ALUMINUM / STEEL	

1 - SEPARATE YOKE 14" NB & ABOVE
2 - SEAL WELD 3" NB & ABOVE
3 - INTEGRAL BACK SEAT FOR AUSTENITIC STEEL VALVES
4 - SEAT & WEDGE STELLITING OPTIONAL

Class 300

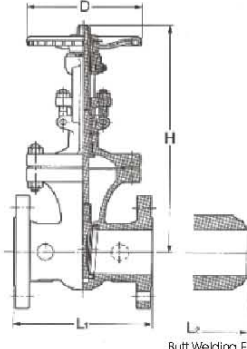

Butt Welding End

Dimensions

Valve Size	in	1 1/2	2	2 1/2	3	4	5	6	8	10	12	14	16	18	20
		mm	40	50	65	80	100	125	150	200	250	300	350	400	450
L 1	in	7.50	8.50	9.50	11.14	12.00	15.00	15.86	16.50	18.00	19.76	30.00	33.00	36.00	39.00
	mm	190	216	241	283	305	381	403	419	457	502	762	838	914	991
L 2	in	7.50	8.50	9.50	11.14	12.00	15.00	15.86	16.50	18.00	19.76	30.00	33.00	36.00	39.00
	mm	190	216	241	283	305	381	403	419	457	502	762	838	914	991
H	in	14.7	16.2	17.9	20.8	24.1	27.2	31.1	39.9	47.8	56.6	61.5	68.1	76.0	84.1
	mm	351	351	430	507	587	587	757	958	1162	1361	1523	1693	1887	2120
D	in	7.9	7.9	7.9	9.8	9.8	11.8	13.8	15.7	17.7	17.7	19.7	23.6	26.8	29.9
	mm	200	200	200	250	300	300	350	400	450	500	500	600	600	760

GEAR OP.

REFERENCE STANDARD	
MFG. STD.	API 600
FACE TO FACE	ASME B 16.10
FLANGE DETAIL	ASME B 16.5
INSP. & TEST.	API 598
PRESS TEMP.	ASME B 16.34

Class 600

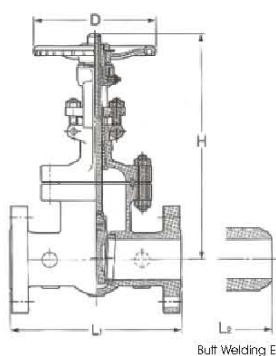

Butt Welding End

Dimensions

Valve Size	in	2	2 1/2	3	4	5	6	8	10	12	14	16	18	20
		mm	50	65	80	100	125	150	200	250	300	350	400	450
L 1	in	11.50	13.00	14.00	17.00	20.00	22.00	26.00	31.00	33.00	35.00	39.00	43.00	47.00
	mm	292	330	356	432	508	559	660	787	838	889	991	1092	1194
L 2	in	11.50	13.00	14.00	17.00	20.00	22.00	26.00	31.00	33.00	35.00	39.00	43.00	47.00
	mm	292	330	356	432	508	559	660	787	838	889	991	1092	1194
H	in	17.6	19.6	21.4	26.2	30.3	35.1	41.9	49.5	57.6	62.7	70.0	81.5	88.2
	mm	447	499	544	666	770	892	1065	1257	1464	1593	1779	2071	2240
D	in	7.9	9.8	9.8	11.8	15.7	17.7	19.7	23.6	26.8	29.9	35.8	35.8	23.6
	mm	250	250	350	400	400	500	500	650	680	760	760	800	800

GEAR OP.

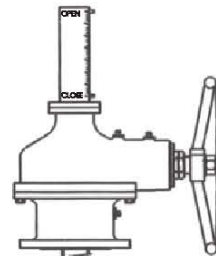

GEAR OPERATION

H-shaped flexible wedges are featured with mechanical flexibility to adjust its own shape following the shape of the body seats for tightly secured mutual contact. This is particularly important when larger gate valves service extremely high pressure and temperature, where temporary deformation of the valve body always occurs. Operational torque is smaller, seat wear is less and valve closure is tighter when H-shaped flexible wedges are provided.



FLEXIBLE WEDGE

CAST STEEL GLOBE VALVE

Bolted bonnet. Outside screw-&-yoke, Rising stem & handwheel, Swivel disc

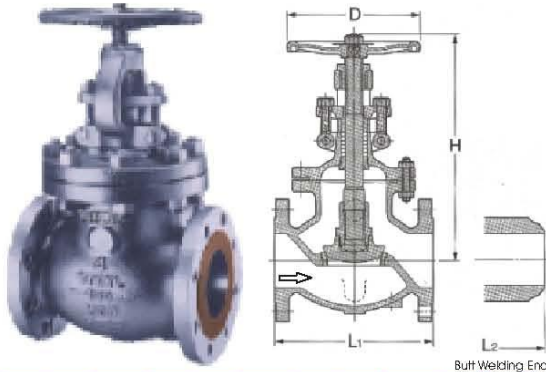

Dimensions

Valve Size	in	1/2	2	2 1/2	3	4	5	6	8	10	12	14	16
		mm	40	50	65	80	100	125	150	200	250	300	350
L 1	in	6.50	8.00	8.50	9.50	11.50	14.00	16.00	19.50	24.50	27.50	31.00	36.00
	mm	165	203	216	241	292	356	406	495	622	698	787	914
L 2	in	6.50	8.00	8.50	9.50	11.50	14.00	16.00	19.50	24.50	27.50	31.00	36.00
	mm	165	203	216	241	292	356	406	495	622	698	787	914
H	in	12.2	13.1	14.1	15.4	18.1	19.1	20.2	24.8	37.6	40.4	42.6	48.1
	mm	310	351	359	390	460	484	513	630	955	1025	1082	1222
D	in	7.9	7.9	8.9	9.8	9.8	11.8	13.8	15.7	19.7	19.7	23.6	23.6
	mm	200	200	250	250	300	350	400	450	500	500	500	600

GEAR OP.

Class 600

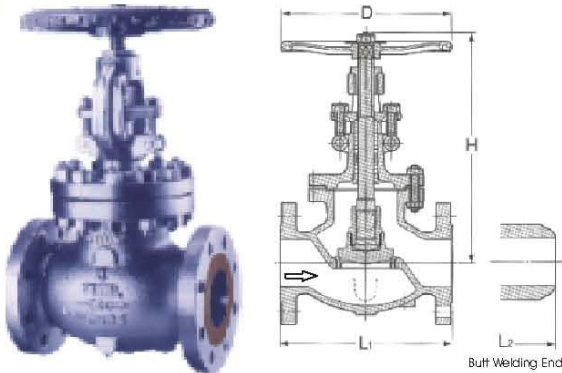

Dimensions

Valve Size	in	2	2 1/2	3	4	6	8	10	12
		mm	50	65	80	100	150	200	250
L 1	in	11.50	13.00	14.00	17.00	22.00	26.00	31.00	33.00
	mm	292	330	356	432	529	660	787	838
L 2	in	11.50	13.00	14.00	17.00	22.00	26.00	31.00	33.00
	mm	292	330	356	432	559	660	787	838
H	in	15.7	18.7	19.9	34.5	38.1	45.9	52.0	62.2
	mm	400	475	506	877	967	1165	1320	1580
D	in	9.8	11.8	13.8	19.7	19.7	23.6	23.6	24.0
	mm	250	300	350	400	500	600	600	600

G.O.

Class 300

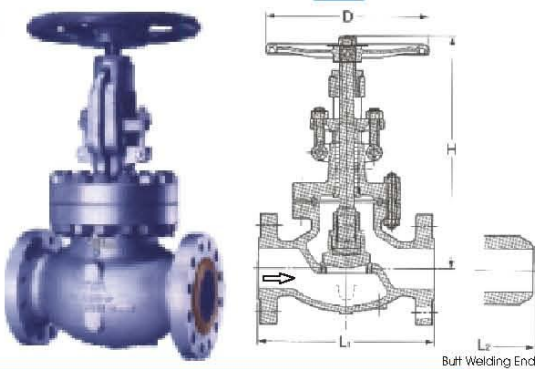

Dimensions

Valve Size	in	1/2	2	2 1/2	3	4	5	6	8	10	12
		mm	40	50	65	80	100	125	150	200	250
L 1	in	9.00	10.50	11.50	12.50	14.00	15.75	17.50	22.00	24.50	28.00
	mm	229	267	292	318	356	400	444	559	622	711
L 2	in	9.00	10.50	11.50	12.50	14.00	15.75	17.50	22.00	24.50	28.00
	mm	229	267	292	318	356	400	444	559	622	711
H	in	13.4	14.3	15.8	17.4	20.1	24.0	27.0	40.9	44.9	46.7
	mm	341	362	402	441	510	610	685	1038	1141	1186
D	in	7.9	7.9	9.8	9.8	13.8	15.7	17.7	19.7	23.6	23.6
	mm	200	250	300	350	450	500	550	500	600	600

GEAR OP.

Material Specification

PARTS	MATERIAL		
BODY	WCB	WC6	CF8/ CF8M
BONNET	WCB	WC6	CF8/ CF8M
PLUG	13% Cr. FACING WCB	WC6+ 13% Cr. FACING	CF8/ CF8M
SEAT RING	13% Cr. FACING	S.S. 304	CF8/ CF8M
BACK SEAT	T410		INTEGRAL
SPINDLE	T410		T304 / T316
GLAND BUSH	T410		T304 / T316
GLAND FLANGE	CARBON STEEL / WCB		S.S. 304
YOKE NUT	ASTM A 439 Gr. D2 / AL-BONZE		
PLUG NUT	T410		T304
HAND WHEEL	CARBON STEEL		
HAND WHEEL NUT	Gr. 2H		Gr. B
STUD & NUT	B7 / 2H	B16 / 7	B7 / 2H
EYE BOLT & NUT	B7 / 2H		B8 / 8
CROSS BOLT & NUT	B7 / 2H		B8 / 8
GASKET	SPW S.S. 304 / 316 WITH GRAFOIL		
GLAND PACKING	GRAPH. ASB. INHB. & INCONEL WIRE REIN GRAFOIL		
THRUST WASHER	T410 (HARDENED STEEL)		T304 / T316
WASHER	STEEL		
GRUB SCREW	STEEL		
LOCK NUT	STEEL		
NAME PLATE	ALUMINUM / SS		

1 - SEAL WELD 3" NB & ABOVE
 2 - INTEGRAL BACK SEAT FOR AUSTENITIC STEEL VALVES
 3 - SEAT & PLUG STRENGTHENING OPTIONAL
 4 - THRUST BEARING, NON-ROTATING STEM WITH YOKE SLEEVE VALVE PROVIDED 12" NB & ABOVE SIZES.
 5 - GUIDED DISC PROVIDED 12" NB & ABOVE.
 6 - SCREW DOWN NON RETURN (SDNR) CONSTRUCTION CAN BE OFFERED IF REQUIRED

VARIOUS PLUG DESIGN

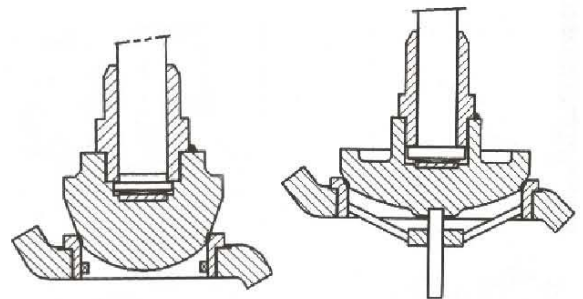

Regulating Type Disc

Guided-Disc Seat

REFERENCE STANDARD

MFG. STD.	BS 1873
FACE TO FACE	ASME B 16.10
FLANGE DETAIL	ASME B 16.5
INSP. & TEST.	BS 6755
PRESS TEMP.	ASME B 16.34

CAST STEEL CHECK VALVE

Bolted cover, Swing type disc.

Class 150

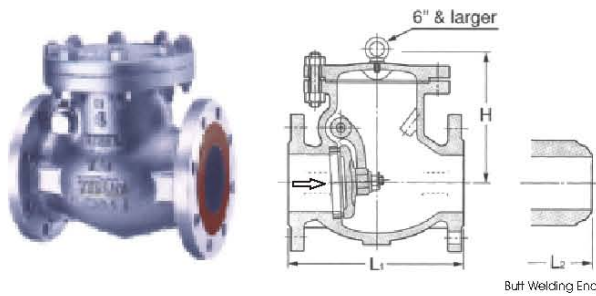

Dimensions

Bolted cover, Swing type disc.

Valve Size	in	1/2	2	2 1/2	3	4	5	6	8	10	12	14	16	18	20	22	24
		mm	40	50	65	80	100	125	150	200	250	300	350	400	450	500	550
L 1	in	6.5	8.0	8.5	9.5	11.5	13.0	14.0	19.5	24.5	27.5	31.0	34.0	38.5	38.5	42.0	51.0
	mm	165	203	216	241	292	330	356	495	622	698	787	864	978	978	1067	1295
L 2	in	6.5	8.0	8.5	9.5	11.5	13.0	14.0	19.5	24.5	27.5	31.0	34.0	38.5	38.5	42.0	51.0
	mm	165	203	216	241	292	330	356	495	622	698	787	864	978	978	1067	1295
H	in	5.3	6.0	6.7	7.1	7.9	9.25	9.8	11.6	13.2	14.5	16.3	18.1	20.1	21.7	23.0	24.8
	mm	135	152	170	180	200	235	250	295	334	368	415	460	510	550	585	630

Material Specification

PARTS	MATERIAL		
BODY	WCB	WC6	CF8/ CF8M
DISC	13% Cr. FACING ON WCB	WC6+ 13% Cr.	CF8/ CF8M
SEAT RING 1	515 Gr.70+ 13% Cr. FACING	S.S. 304	T304 / T316
TOP COVER	WCB	WC6	CF8/ CF8M
STUD & NUT	B7 / 2H	B16 / 7	B7 / 2H
BRACKET STUD & NUT	B8 / 8		
GASKET	SPW S.S. 304 / 316 WITH GRAFOIL		
WASHER	T410	T304	T316
DISC NUT	Gr.8		
HINGE PIN	T410	T304	T316
SPILT PIN	T410	T304	T316
NAME PLATE	ALUMINIUM / SS		
HINGE	WCB	WC6/ CF8	CF8/ CF8M
HINGE BRACKET	WCB	WC6/ CF8	CF8/ CF8M
LIFTING EYE BOLT	ASTM A 105		

- 1 - SEAL WELD 3" NB & ABOVE
- 2 - LIFTING EYE BOLT 8"NB AND ABOVE.
- 3 - DISC & SEAT STELLITING OPTIONAL

Class 300

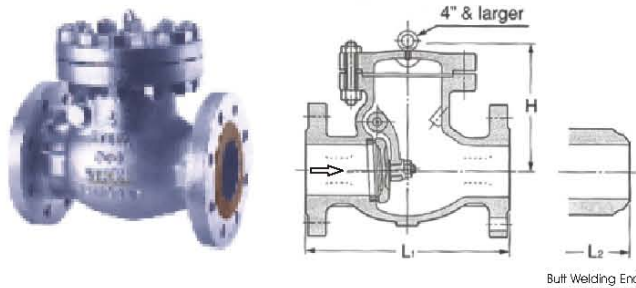

Dimensions

Bolted cover, Swing type disc.

Valve Size	in	1/2	2	2 1/2	3	4	6	8	12	14	16	18	20
		mm	40	50	65	80	100	150	200	300	350	400	450
L 1	in	9.50	10.50	11.50	12.50	14.00	17.50	21.00	28.00	33.00	34.00	38.50	40.00
	mm	241	267	292	318	356	444	533	711	838	864	987	1016
L 2	in	9.50	10.50	11.50	12.50	14.00	17.50	21.00	28.00	33.00	34.00	38.50	40.00
	mm	241	267	292	318	356	444	533	711	838	864	987	1016
H	in	5.5	6.5	7.5	8.1	8.9	10.7	13.00	16.0	18.9	21.1	22.60	24.8
	mm	140	165	190	205	225	272	330	406	480	535	575	630

REFERENCE STANDARD

MFG. STD.	BS 1868
FACE TO FACE	ASME B 16.10
FLANGE DETAIL	ASME B 16.5
INSP. & TEST.	BS 6755 PART-I
PRESS TEMP.	ASME B 16.34

Class 600

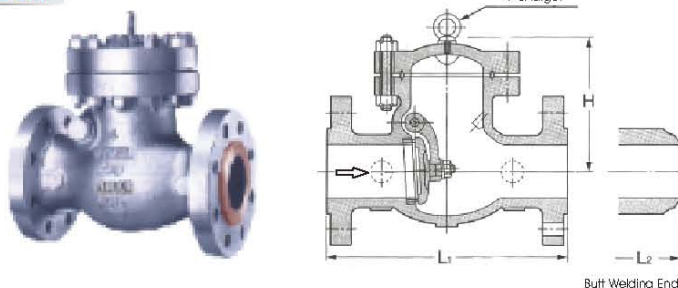

Dimensions

Bolted cover, Swing type disc.

Valve Size	in	2	2 1/2	3	4	6	8	10	12	14	16	18	20
		mm	50	65	80	100	150	200	250	300	350	400	450
L 1	in	11.50	13.00	14.00	17.00	22.00	26.00	31.00	33.00	35.00	39.00	43.00	47.00
	mm	292	330	356	432	559	660	787	838	889	991	1092	1194
L 2	in	11.50	13.00	14.00	17.00	22.00	26.00	31.00	33.00	35.00	39.00	43.00	47.00
	mm	292	330	356	432	559	660	787	838	889	991	1092	1194
H	in	7.1	7.8	8.7	10.1	12.5	14.0	16.3	17.7	21.9	23.7	25.00	27.8
	mm	180	197	220	256	318	356	415	450	556	601	635	707

SWING CHECK VALVE
WITH DASH POT
ARRANGEMENT

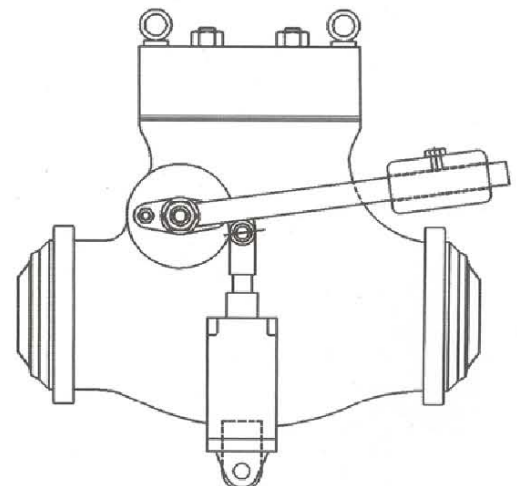

DUAL PLATE RETAINERLESS WAFER CHECK VALVE

Dual-plate Retainer Less Wafer Type Check Valve

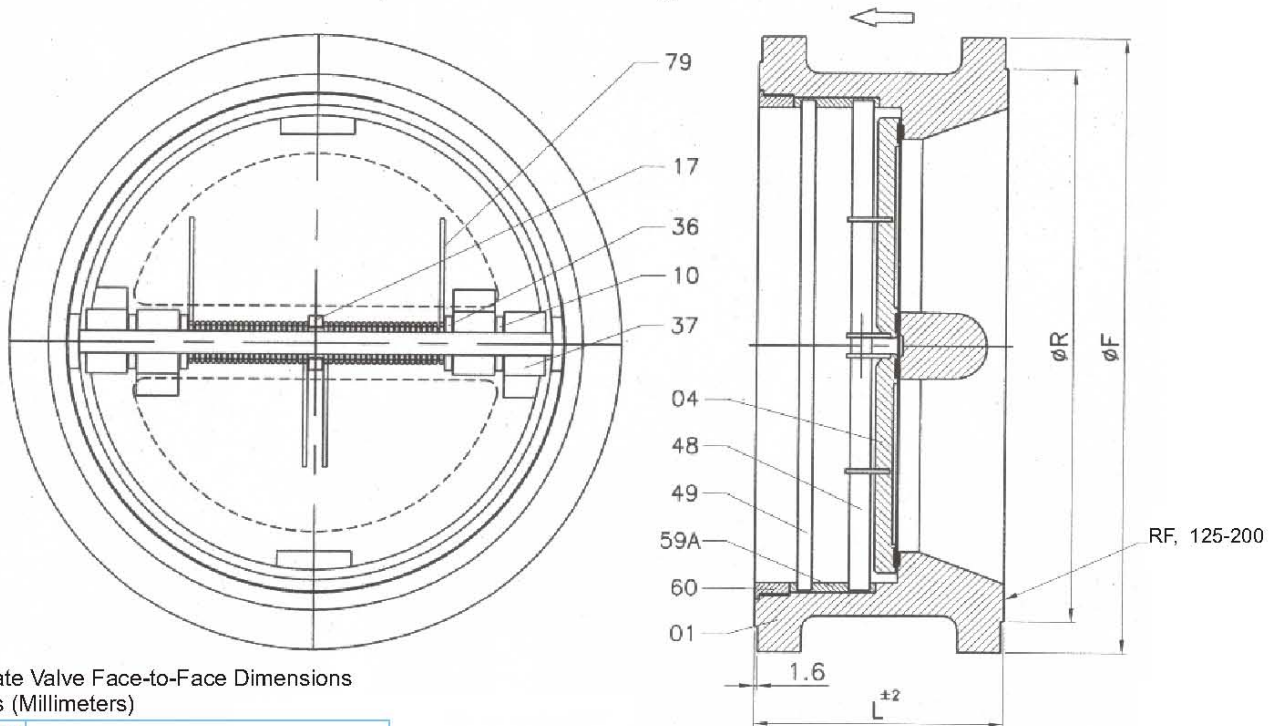

Dual-Plate Valve Face-to-Face Dimensions by Class (Millimeters)

Valve Size (NPS)	125	250	150	300	400	600	900	1500
2	54	54	60	60	60	60	70	70
2 1/2	60	60	67	67	67	67	83	83
3	67	67	73	73	73	73	83	83
4	67	67	73	73	79	79	102	102
5	83	83	-	-	-	-	-	-
6	95	95	98	98	136	136	159	159
8	127	127	127	127	165	165	206	206
10	140	140	146	146	213	213	241	248
12	181	181	181	181	229	229	292	305
14	184	222	184	222	273	273	356	356
16	191	232	191	232	305	305	384	384
18	203	264	203	264	362	362	451	468
20	213	292	219	292	368	368	451	533
24	222	318	222	318	394	438	495	559
30	305	368	305	368	460	505	-	-
36	386	483	368	483	635	635	-	-
42	432	568	432	568	701	701	-	-
48	524	629	524	629	-	-	-	-
54	-	-	*	*	-	-	-	-
60	-	-	*	*	-	-	-	-

Note : The face-to-face tolerance shall be as specified in ASME B16.10 for sizes through NPS 24 and shall be 0.125 inch (3mm) for sizes larger than NPS 24.

DESCRIPTION	MATERIAL
BODY	ASTM A 216 Gr. WCB
PLATE	13% Cr. STEEL
SEAT	WCB+13% Cr. STEEL
DISC BEARING	AISI 410
SPACER BUSH	AISI 410
SPRING BEARING	AISI 410
BODY BEARING	AISI 410
HINGE PIN	ASTM A 276 T304
STOPPER PIN	ASTM A 276 T304
LIFTING HOOK (8" ABOVE)	ASTM A 105
PIN HOUSING	AISI 304
LOCKING RING	ASTM A 515 Gr. 70
SPRING	SS 304

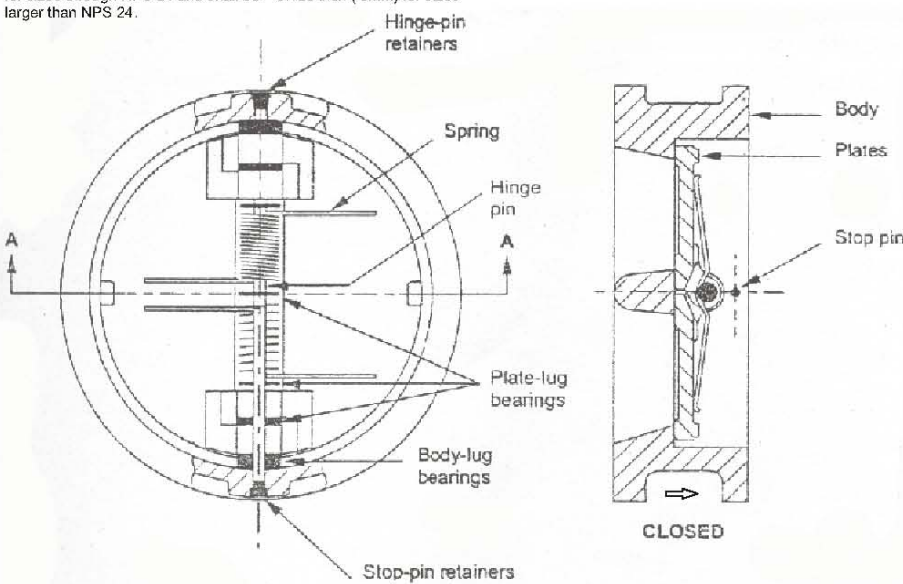

Typical Dual-Plate Wafer Check Valve

REFERENCE STANDARD	
MFG. STD.	API 594
FACE TO FACE	API 594
INSP. & TEST.	BS 6755
PRESS. TEMP.	ASME B 16.34

Gate Valve

BS 5352 AND API 602

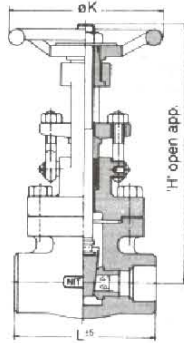

Dimensions Table GTV - Reduced Bore

Valve Size	in	0.25	0.37	0.5	0.75	1	1.5	2
	mm	08	10	15	20	25	40	50
L	in	3.3	3.3	3.3	3.5	4	5	5.6
	mm	85	85	85	90	103	128	142
'H' app		165	165	165	175	215	270	285
ϕK app		95	95	95	95	105	150	150
ϕP		6.4	6.4	9.5	12.7	17.5	28.6	36.5
Wt. kg. app		2.0	2.0	2.0	2.5	3.5	7.5	9

Material Specification

PARTS	MATERIAL		
BODY	A 105	F 304	F 316
BONNET	A 105	F 304	F 316
WEDGE/ PLUG	13% Cr.	T 304	T 316
SEAT	13% Cr.	T 304	T 316
SPINDLE	T 410	T 304	T 316
GLAND FLANGE	A 105	F 304	
YOKE SLEEVE YOKE NUT	ASTM A 439 Gr. D2/ AL-BRONZE		
HAND WHEEL	CARBON STEEL		
HAND WHEEL NUT	Gr.2H		
BOLT/ STUD & NUT	B7/ 2H	B8/ 8 OR B7/ 2H	
EYE BOLT & NUT	B7/ 2H	B8/ 8	
GASKET	SPW S.S. 304 / 316 WITH CAF / GRAFOIL		
GLAND PACKING	GRAFOIL / INCONEL WIRE REIN.		
SCREW / RIVET & WASHER	STEEL		
BEARING WASHER	HARDENED STEEL		
GRUB SCREW	Gr. B7		
GREASE NIPPLE	C. S. (NICKLE PLATED)		
NAME PLATE	ALUMINIUM / SS		

1 - STELLITING ON WEDGE / DISC / SEAT OPTIONAL

Globe Valve

BS 5352

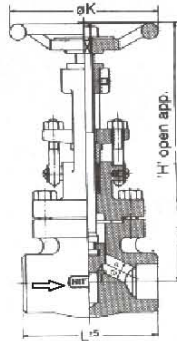

Dimensions Table GBV - Reduced Bore

Valve Size	in	0.25	0.37	0.5	0.75	1	1.5	2
	mm	08	10	15	20	25	40	50
L	in	3.3	3.3	3.3	3.5	4	5	5.6
	mm	85	85	85	90	103	128	142
'H' app		170	170	170	180	210	280	290
ϕK app		95	95	95	95	105	150	150
ϕP		6.0	6.0	9.0	12.0	17.5	29.5	35.0
Wt. kg. app		2.0	2.0	2.0	2.5	4.0	8.5	9

Material Specification

PARTS	MATERIAL		
BODY	A 105	F 304	F 316
PLUG	13% Cr.	T 304	T 316
SEAT RING	13% Cr.	T 304	T 316
COVER	A 105	F 304	F 316
COLLAR BOLT/ STUD & NUT	B7/ 2H	B8/ 8 OR B7/ 2H	
GASKET	SPW S.S. 304 / 316 WITH CAF / GRAFOIL		
NAME PLATE	ALUMINIUM / SS		

Check Valve

BS 5352 Reduced bore

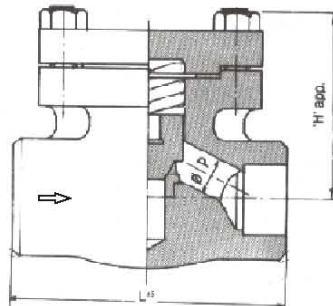

Dimensions Table CKV - Reduced Bore

Valve Size	in	0.25	0.37	0.5	0.75	1	1.5	2
	mm	08	10	15	20	25	40	50
L	in	3.3	3.3	3.3	3.5	4	5	5.6
	mm	85	85	85	90	103	128	142
'H' app		60	60	60	70	80	105	115
ϕP		6.0	9.0	12.0	17.5	29.5	35.0	
Wt. kg. app		1.5	1.5	1.5	2.0	2.5	6	8

Ball Valve 800 Class

BS 5351

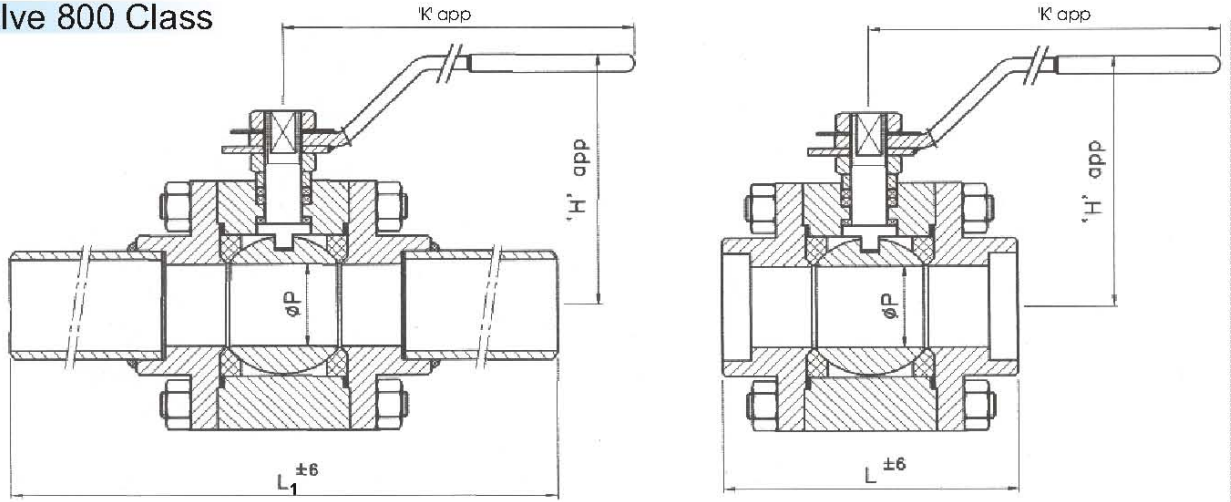

Dimensions Table 800 Class

Valve Size	in	0.5	0.75	1	1.25	1.5	2
	mm	15	20	25	32	40	50
L		3.1 80	3.3 85	3.9 100	4.5 115	5.1 130	5.9 150
L 1		10.8 275	11.0 280	11.8 300	12.4 315	12.6 320	13.8 350
'H' app		70	80	90	105	110	125
'K' app		130	140	160	240	240	240
∅ P		12	19	24	30	37	50

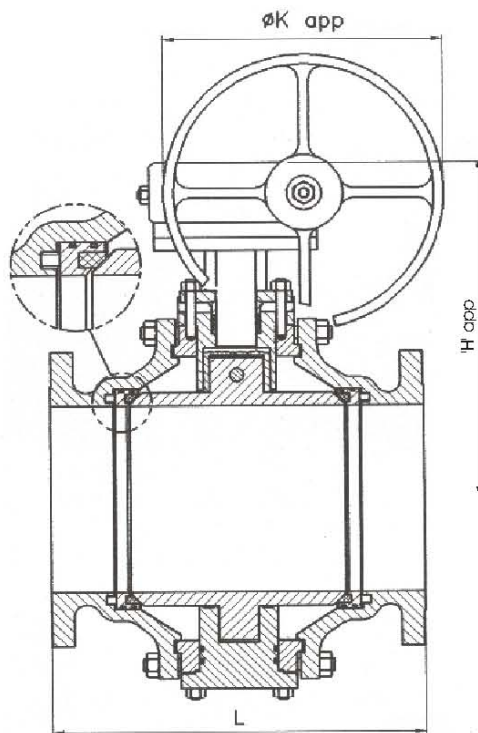
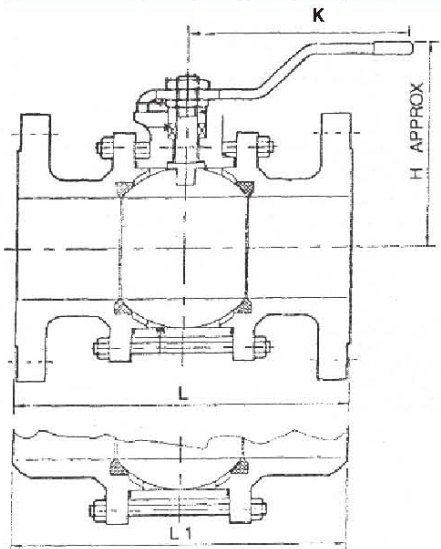

DESCRIPTION :

- SIZE : 15mm to 300mm
- MOC : Cast Steel / Forged Steel
- ENDS : Screwed / S.W. / B.W. / Flanged
- CONST : Three / Two / Single Piece
- BORE : Full / Reduced
- BALL : Floating / Trunion
- OPTR : Lever / Gear / Actuator
- DESIGN : Fire Safe / Non Fire Safe

APPLICABLE STANDARDS

- Face-to-Face : ANSI B 16.10
- End Flanges : ANSI B 16.5
- BW Ends : ANSI B 16.25
- Manufacturing : BS 5351 / API 6 D
- Testing : BS 6755
- Pressure - Temp. Rating : ANSI B 16.34

Material Specification

PARTS	MATERIAL	
BODY	WCB / A105	CF8 / CF8M
BALL	T304 / CF8 / T316 CF8M	
SEAT	PTFE	
SPINDLE	T 410 / T304	T 304 / 316
GLAND BUSH	T 410 / T304	T 304 / 316
HANDLE NUT	STEEL	T 304
STUD & NUT	B7 / 2H	
GASKET	PTFE	
GLAND PACKING	PTFE	
BOTTOM WASHER	PTFE	
END PIECE	WCB	CF8 / CF8M
GLAND NUT	CARBON STEEL	T 304 / 316
NAME PLATE	ALUMINIUM / SS	
POSITION INDICATOR	ALUMINIUM / SS	

1 - HOLLOW BALL 3"NB AND ABOVE
 2 - GEAR OPERATION 10"NB AND ABOVE
 3 - TRUNION MOUNTED BALL AS PER REQUIREMENT.

Dimensions Table 150 Class

Valve Size	in	1	1.5	2	2.5	3	4	6	8	10	12
	mm	25	40	50	65	80	100	150	200	250	300
L		5.0 127	6.5 165	7.0 178	7.5 190	8.0 203	9.0 229	15.5 394	18.0 457	21.0 533	24.0 610
'H' app		95	100	125	140	175	195	270	325	390	540
'K' app		220	220	220	320	320	385	500	600	450	450

Dimensions Table 300 Class

Valve Size	in	1	1.5	2	2.5	3	4	6	8
	mm	25	40	50	65	80	100	150	200
L		6.5 165	7.5 190	8.5 216	9.5 241	11.1 283	12.0 305	15.9 403	19.75 502
'H' app		95	100	125	140	175	195	235	360
'K' app		220	220	220	320	320	385	500	450

Dimensions Table 600 Class

Valve Size	in	1.5	2	2.5	3	4	6	8
	mm	40	50	65	80	100	150	200
L		9.5 241	11.5 292	13 330	14.0 356	17.0 432	22.0 559	26.0 600
'H' app		125	135	150	200	250	450	500
'K' app		220	320	350	400	450	450	500

DOUBLE FLANGED BUTTERFLY VALVES

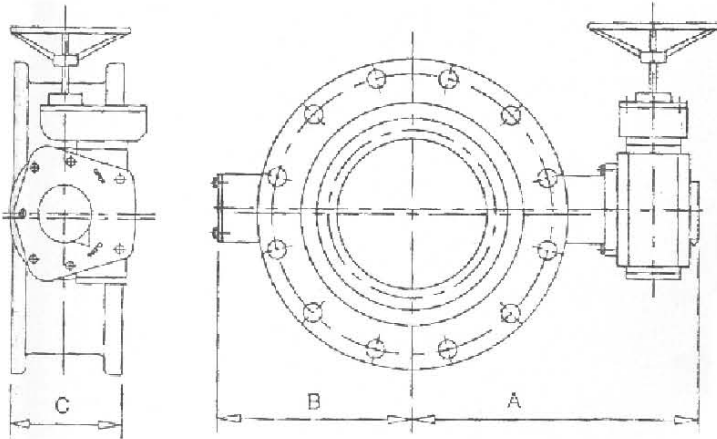

APPLICABLE STANDARDS

Mfg. Std. : BS 5155 / ISO 5752
 Test Std. : API 598 / BS 6755
 Drilling Std. : ANSI / BS / DIN / ISO / AWWA
 Pressure Rating : PN 6 / PN 10 / PN 16 PN 25

DESCRIPTION :

Size : 200 mm to 2000 mm
 Ends : Flanged
 OPTR : Gear / Actuator
 Design : Double Eccentric

Material Specification

DESCRIPTION	QTY.	MATERIAL
HANDWHEEL	1	CARBON STEEL
WORM GEAR	-	STANDARD
BEARING	2	BRONZE
BRACKET	1	CARBON STEEL
BOTTOM PLUG	1	HTS
PACKING RING	2	GRAFOIL
GLAND FLANGE	1	C.S.
GLAND	1	C.S.
GLAND PACKING	SET	GRAFOIL
SPLIT RING	1	AISI 316
TAPER PIN	2	AISI 316
CLAMPING RING	1	C.S.
SHAFT	2	AISI 410 / 304
SEAT	1	S.S. 304 / 316
DISC	1	CS A 216 GR. WCB
BODY	1	CS A 216 GR. WCB

SIZE (MM)	A	B	C	
			BS 5155	AWWA C 504
200	355	190	152	152
250	360	225	165	203
300	430	270	178	203
350	500	300	190	203
400	530	325	216	203
500	600	380	229	203
600	730	450	267	203
700	830	520	292	305
800	885	555	318	305
900	950	660	330	305
1000	1000	700	410	305
1100	1050	750	440	343
1200	1190	865	470	381
1400	1410	1040	530	381
1500	1500	1100	565	381
1600	1560	1160	600	458
1800	1660	1260	670	458

HIGH PERFORMANCE BUTTERFLY VALVES

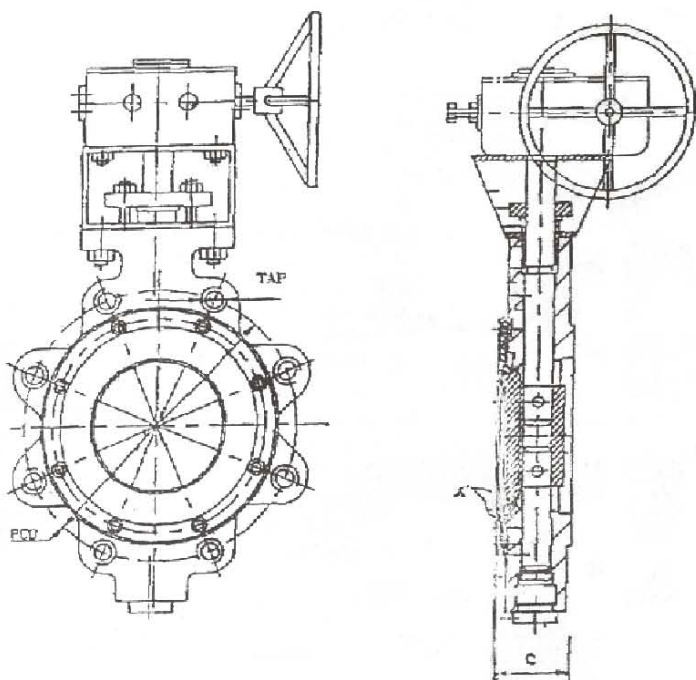

Face-to-Face Dimensions for Category B Valves

(A) LUG-AND WAFER-TYPE

VALVE SIZE (NPS)	CLASS 150		CLASS 150	
	Inches	Millimeters	Inches	Millimeters
3	1.88	48	1.88	48
4	2.12	54	2.12	54
6	2.25	57	2.31	59
8	2.50	64	2.88	73
10	2.81	71	3.25	83
12	3.19	81	3.62	92
14	3.62	92	4.62	117
16	4.00	102	5.25	133
18	4.50	114	5.88	149
20	5.00	127	6.25	159
24	6.06	154	7.12	181

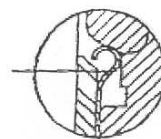

- 1) FLANGE STD - ANSI 150 #
- 2) VALVE RATING - 150 #
- 3) MFG STD - API 609 & TEST STD - API 598

STEEL PIPE FLANGES

ASME B16.5 Class 150 RF to 600 RF

for Class 150 & 300

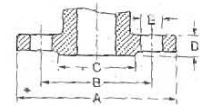

for Class 600

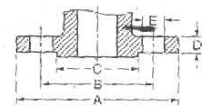

► Class 150 RF

Nominal Size		A		B		C		D		E		BOLT	
in	mm	in	mm	in	mm	in	mm	in	mm	in	mm	Number	Diam
2	50	6.00	152	4.75	120.5	3.62	92	0.75 (0.62)	19.1 (15.9)	0.75	19	4	5/8
2.5	65	7.00	178	5.50	139.5	4.12	105	0.88 (0.69)	22.3 (17.5)	0.75	19	4	5/8
3	80	7.50	190	6.00	152.5	5.00	127	0.94 (0.75)	23.9 (19.1)	0.75	19	4	5/8
4	100	9.00	229	7.50	190.5	6.19	157	0.94	23.9	0.75	19	8	5/8
5	125	10.00	254	8.50	216	7.31	186	0.94	23.9	0.88	22	8	3/4
6	150	11.00	279	9.50	241.5	8.50	216	1.00	25.4	0.88	22	8	3/4
8	200	13.50	343	11.75	298.5	10.62	270	1.12	28.6	0.88	22	8	3/4
10	250	16.00	406	14.25	362.0	12.75	324	1.19	30.2	1.00	25	12	7/8
12	300	19.00	483	17.00	432	15.00	381	1.25	31.8	1.00	25	12	7/8
14	350	21.00	533	18.75	476.5	16.26	413	1.38	35.0	1.12	29	12	1
16	400	23.50	597	21.25	539.5	18.50	470	1.44	36.6	1.12	29	16	1
18	450	25.00	635	22.75	578.0	21.00	533	1.56	39.7	1.25	32	16	1 1/8
20	500	27.50	698	25.00	635	23.00	584	1.69	42.9	1.25	32	20	1 1/8
24	600	32.00	813	29.50	749.5	27.25	692	1.88	47.7	1.38	35	20	1 1/4

Height of raised face is 0.06" (1.6mm) each.

Dimensions in () are for valve flanges.

► Class 300 RF

Nominal Size		A		B		C		D		E		BOLT	
in	mm	in	mm	in	mm	in	mm	in	mm	in	mm	Number	Diam
2	50	6.50	165	5.00	127.0	3.62	92	0.88	22.3	0.75	19	8	5/8
2.5	65	7.50	190	5.88	149.0	4.12	105	1.00	25.4	0.88	22	8	3/4
3	80	8.25	210	6.62	168.0	5.00	127	1.12	28.6	0.88	22	8	3/4
4	100	10.00	254	7.88	200.0	6.19	157	1.25	31.8	0.88	22	8	3/4
5	125	11.00	279	9.25	235.0	7.31	186	1.38	35.0	0.88	22	8	3/4
6	150	12.50	318	10.62	270.0	8.50	216	1.44	36.6	0.88	22	12	3/4
8	200	15.00	381	13.00	330.0	10.62	270	1.62	41.3	1.00	25	12	7/8
10	250	17.50	444	15.25	387.5	12.75	324	1.88	47.7	1.12	29	16	1
12	300	20.50	521	17.75	451.0	15.00	381	2.00	50.8	1.25	32	16	1 1/8
14	350	23.00	584	20.25	514.5	16.25	413	2.12	54.0	1.25	32	20	1 1/8
16	400	25.50	648	22.50	571.5	18.50	470	2.25	57.2	1.38	35	20	1 1/4
18	450	28.00	711	24.75	628.5	21.00	533	2.38	60.4	1.38	35	24	1 1/4
20	500	30.50	775	27.00	686.0	23.00	584	2.50	63.5	1.38	35	24	1 1/4
24	600	36.00	914	32.00	813.0	27.25	692	2.75	69.9	1.62	41	24	1 1/2

Height of raised face is 0.06" (1.6mm) each.

► Class 600 RF

Nominal Size		A		B		C		D		E		BOLT	
in	mm	in	mm	in	mm	in	mm	in	mm	in	mm	Number	Diam
2	50	6.50	165	5.00	127.0	3.62	92	1.00	25.4	0.75	19	8	5/8
2.5	65	7.50	190	5.88	149.0	4.12	105	1.12	28.6	0.88	22	8	3/4
3	80	8.25	210	6.62	168.0	5.00	127	1.25	31.8	0.88	22	8	3/4
4	100	10.75	273	8.50	216.0	6.19	157	1.50	38.1	1.00	25	8	7/8
5	125	13.00	330	10.50	266.5	7.31	186	1.75	44.5	1.12	29	8	1
6	150	14.00	356	11.50	292.0	8.50	216	1.88	47.7	1.12	29	12	1
8	200	16.50	419	13.75	349.0	10.62	270	2.19	55.6	1.25	32	12	1 1/8
10	250	20.00	508	17.00	432.0	12.75	324	2.50	63.5	1.38	35	16	1 1/4
12	300	22.00	559	19.25	489.0	15.00	381	2.62	66.7	1.38	35	20	1 1/4
14	350	23.75	603	20.75	527.0	16.25	413	2.75	69.9	1.50	38	20	1 3/8
16	400	27.00	686	23.75	603.0	18.50	470	3.00	76.2	1.62	41	20	1 1/2
18	450	29.25	743	25.75	654.0	21.00	533	3.25	82.6	1.75	45	20	1 3/8
20	500	32.00	813	28.50	724.0	23.00	584	3.50	88.9	1.75	45	24	1 3/8
24	600	37.00	940	33.00	838.0	27.25	692	4.00	101.6	2.00	51	24	1 7/8

Height of raised face is 0.25" (6.4mm) each.

SPECIAL VALVES AND ACCESSORIES

CHAIN WHEEL ARRANGEMENT

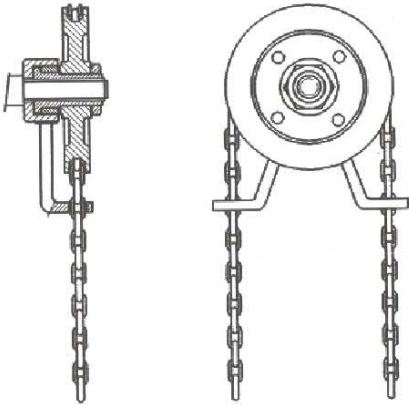

BY-PASS ARRANGEMENT
GATE VALVE

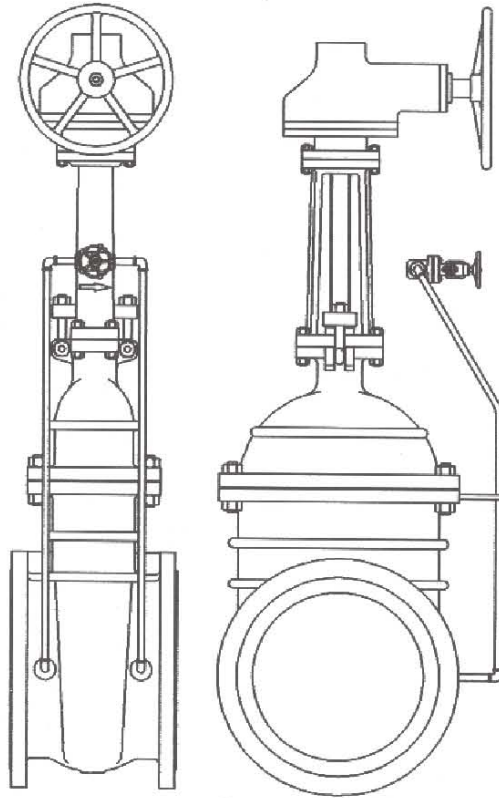

EXTENDED BONNET
GLOBE VALVE

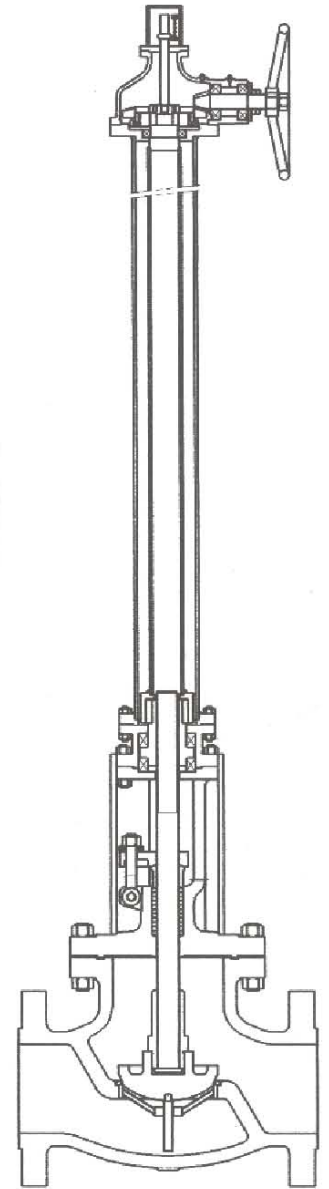

FLUSH BOTTOM VALVE
OPEN IN TO TANK

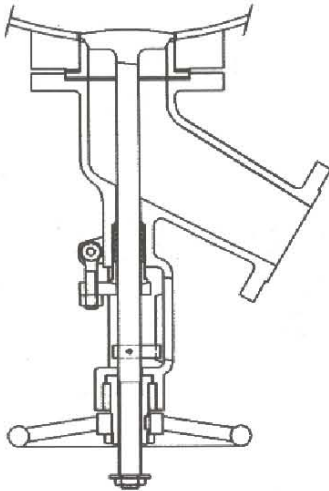

PRESSURE SEAL
GATE VALVE CLASS 900/ 1500/ 2500
API 600

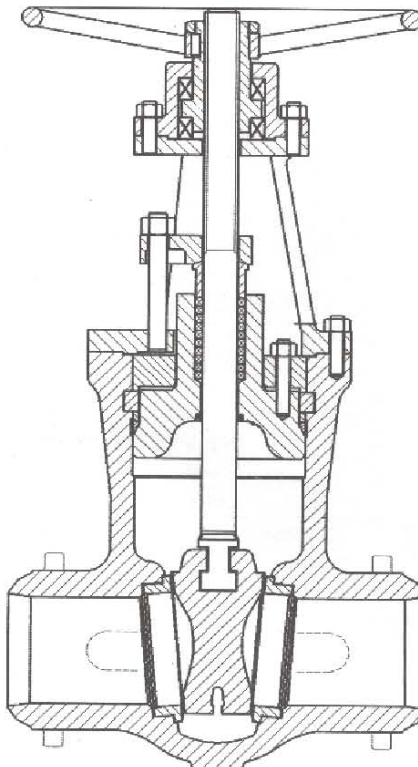

FLUSH BOTTOM VALVE
OPEN IN TO VALVE

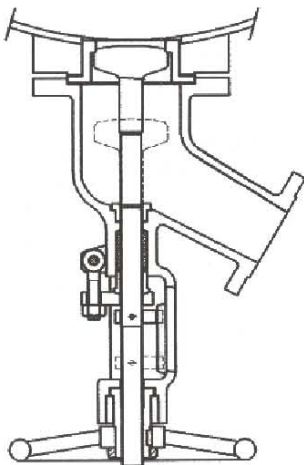

GATE VALVE
FULL JACKETED

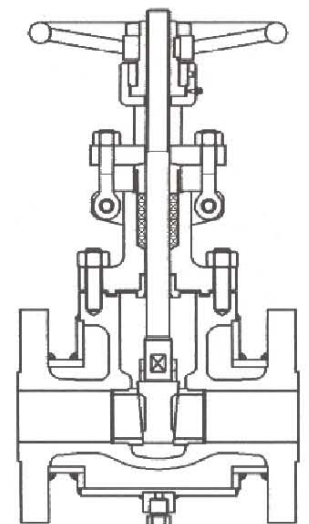

WELDED BONNET
 FORGED STEEL VALVES, CLASS 1500 / 2500
 BS 5352 / API 602 / ASME B 16.34

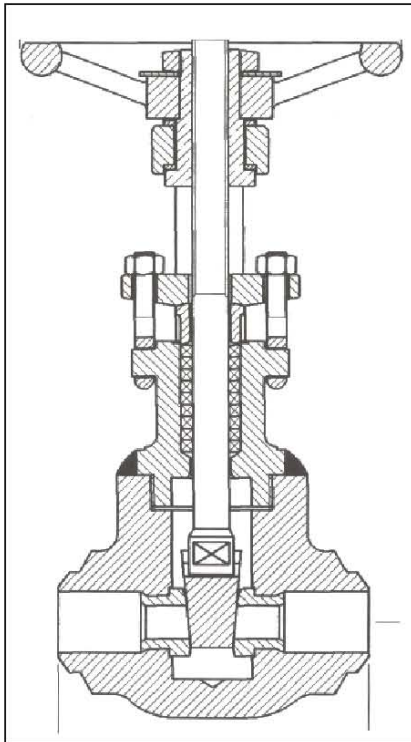

GATE VALVE

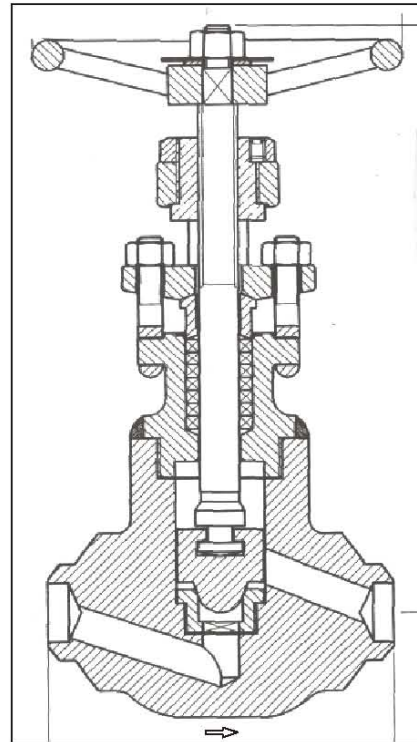

GLOBE VALVE

'Y' TYPE GLOBE VALVE

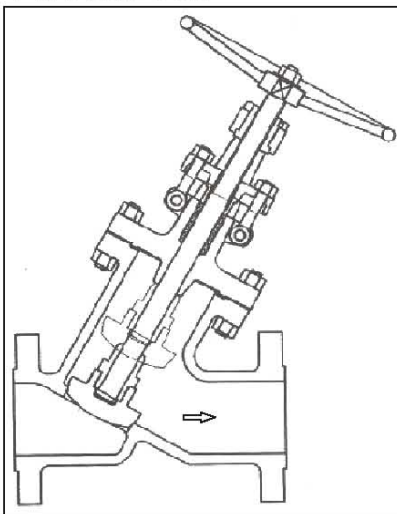

'Y' TYPE STRAINERS

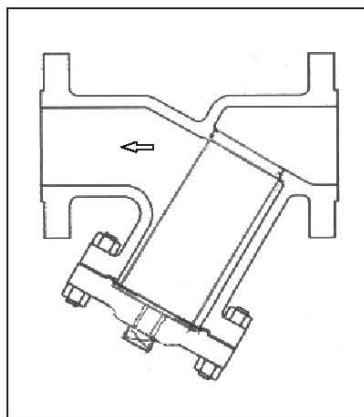

HIGH PRESS,
 ANGLE VALVE
 GEAR WITH
 PRESSURE SEAL
 BONNET

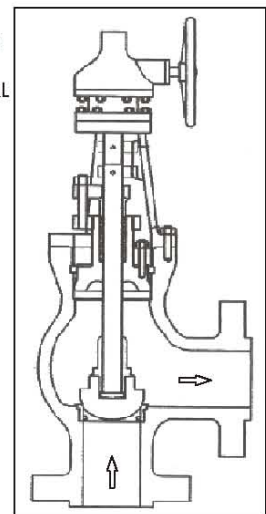

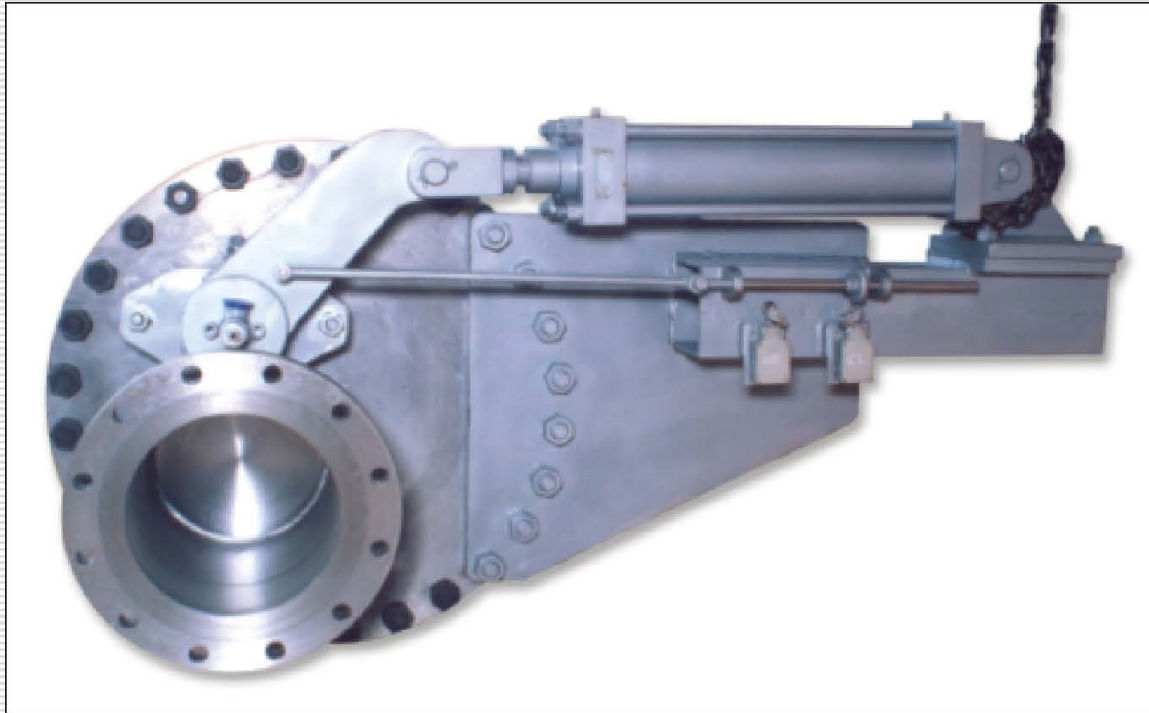

PROCESS SLURRY SLIDE VALVE (HIGH TEMP 750°C)

OUR SPECIALITIES

1. Motor operated valves / Gear operated valves.
2. Process slurry valve for high temperature and medium temperature used in steel industries and cement industries.
3. Helium testing for valves used in Hydrogen service as per ASME section V article 10
4. Manufacturing of import substitute valves.
5. Cryogenic valves for low temperature service with extended bonnet.
6. Jacketed valves, partial and full jacketed
7. Manufacturing and servicing of specialized valves.
8. Shut down maintenance and servicing of valves at site.
9. Special types of pipe fittings.
10. RTJ Ring gaskets.

VITON ENGINEERS PVT. LTD.

Office: 701, 7th Floor, Swastik Disa Corporate Park, Opp. Shreyas Cinema, L.B.S. Marg, Ghatkopar (W), Mumbai - 400 086, Mob. : 08779301215

Factory : Plot No. B-40/1, Addl. Ambernath MIDC, Anand Nagar, Ambernath (E), Dist. Thane - 421506.

E-mail : viton.engg@gmail.com / vitonengg@vitonvalves.com